



Over  
**40** years  
of

**EXCELLENCE**

Service

Integrity

Hard Work

TRUST

**STABILITY**

Quality

Honesty

Team Work

Customer **SATISFACTION**

**Massaro – since 1967**

Bethel Park High School  
Bethel Park, PA

Weekly Progress Slideshow  
September 9, 2011

**Massaro**

# Academic Wing Progress

**“You Got Mail”**



**Case work progression**



# A Gym Equipment Installations



# Black Hawk Drive Base Stone



# Repairs & Walkway to IMS



# And the Paving Begins.....



# Auditorium Progress Ongoing



# IMS Walkway Complete



# Black Hawk Drive Binder Course



# Just Another Day @ BPHS

- Loading Dock Work



- Guided Tours



# Black Hawk Completed!



# Scheduled Work for Next Few Weeks:

- Staging Wood Floor Systems at Gyms
- Installing Gypsum Board
- Interior Painting
- Terrazzo Installation (Athletic Wing)
- Casework Installation (Academic Wing)
- Window & Door Framing
- Framing & Glazing Curtain Walls
- ACT Grid & Tile Installation
- Landscaping items
- Pool Tile Installation
- Casework in Academic Areas
- MEP Final Trim / Installations across the site.
- VCT Installation
- Sprinkler Systems Installations

# Thank You The End

By Chuck DeRito

Senior Site Manager Massaro CMS, LLC

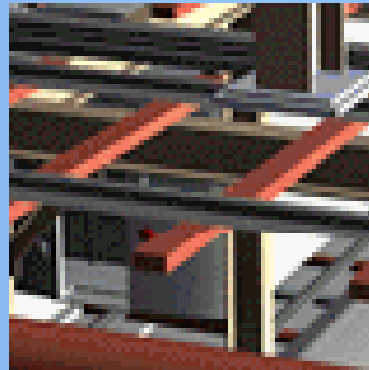

Have a safe and enjoyable Weekend!